

1 2 3 4 5 6 7 8 9

| REV. | LOCAS. | DESCRIPTION | DATE | DRAWN |
|------|--------|------------------|------------|-------|
| 01 | NEW | INITIAL RELEASE. | 2012.08.17 | 張佳燾 |

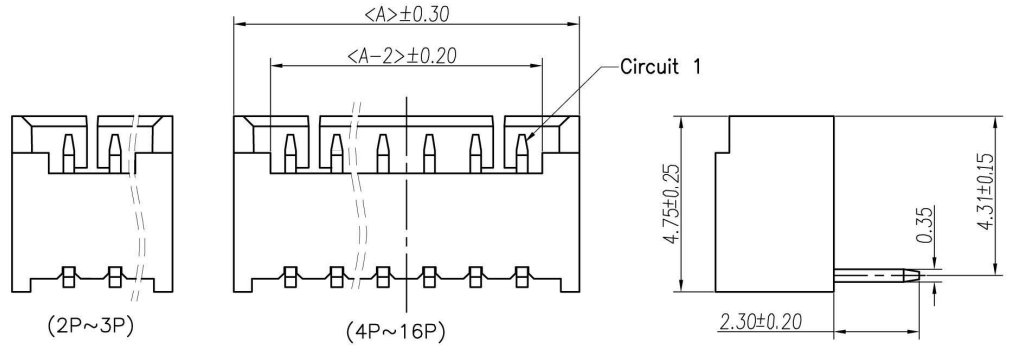

Specifications
 Current Rating: 1A AC,DC
 Voltage Rating: 125V AC,DC
 Contact Resistance: 20mΩ Max.
 Insulation Resistance: 100MΩ Min.
 Dielectric Withstanding: 250V AC/ Minute
 Operating Temperature: -25°C to +85°C

Materials
 Contact Material: Brass
 Insulator Material: Thermoplastic,UL 94V-0
 Nylon 66 or the equivalent material

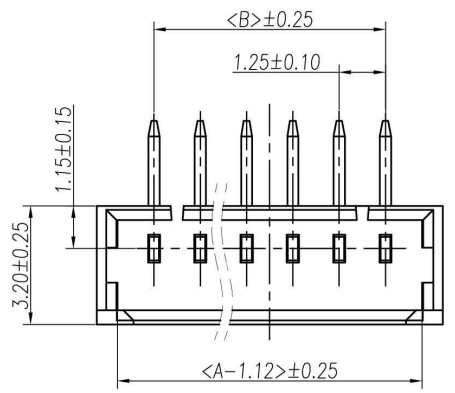

Ordering Information

HCA9814 - XX
 |
 No. of Pins per Row
 02-16

Recommended P.C.Board
 Layout
 (Tolerance: ±0.05)

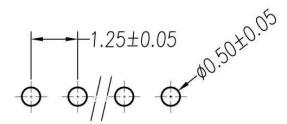

| POLES | DIM:<mm> | | POLES | DIM:<mm> | |
|-------|----------|------|-------|----------|-------|
| | A | B | | A | B |
| 2 | 4.25 | 1.25 | 9 | 13.00 | 10.00 |
| 3 | 5.50 | 2.50 | 10 | 14.25 | 11.25 |
| 4 | 6.75 | 3.75 | 11 | 15.50 | 12.50 |
| 5 | 8.00 | 5.00 | 12 | 16.75 | 13.75 |
| 6 | 9.25 | 6.25 | 13 | 18.00 | 15.00 |
| 7 | 10.50 | 7.50 | 14 | 19.25 | 16.25 |
| 8 | 11.75 | 8.75 | 15 | 20.50 | 17.50 |
| | | | 16 | 21.75 | 18.75 |

HO CHIEN

| GENERAL TOLERANCE | |
|-------------------|-------------|
| X: ±5.0° | X: ±0.30 |
| .X: ±3.0° | .X: ±0.25 |
| .XX: ±2.0° | .XX: ±0.20 |
| .XXX: ±1.0° | .XXX: ±0.10 |

| | | |
|----------|-------|----------|
| DESIGN: | DATE: | DWG. NO. |
| CHECKED: | DATE: | PART NO. |

TITLE:
HCA9814-XX
 1.25 90°
 DIP WAFER

| REV. | UNIT. | SCALE. | PAGE. |
|------|-------|--------|-------|
| 01 | mm | 6:1 | 1/1 |

1 2 3 4 5 6 7 8 9